

CIMARRON LED

Cat.#

Job

Type



Approvals

SPECIFICATIONS

Construction:

- Stylish vertically finned die-cast solid top housing for maximum heat dissipation; Stops collection of unsightly debris from gathering on top of the housing
- Rugged lower die-cast aluminum heat sink accelerates thermal management and optimizes PCB and optical performance
- Separate optical and electrical compartment for optimum component operation
- One piece die cut silicone gasket ensures weather proof seal around each individual LED for IP65 rating
- Backlight Control (BC) option available for 85% spill light reduction, doesn't change fixture appearance or EPA, recommended for Type III and Type IV distributions
- Stamped bezel provides mechanical compression to seal the optical assembly
- Complements the Hubbell Southwest series of outdoor fixtures
- Weight - 45.0 pounds, EPA - 1.3 ft²
- Suitable for applications requiring 3G testing prescribed by ANSI C136.31

Optics:

- Choice of 72 high brightness LED configurations with individual acrylic lenses specially designed for IES Type II, III, IV and V distributions
- Auto optics designed for front row 1A and interior rows 2A (see distribution under ordering and page 2)
- CCT: 3000K (80 CRI), 4000K (70 CRI), 5100K (67 CRI), and turtle friendly Amber LED options
- CRI: 70

Electrical:

- Universal input voltage 120-277 VAC, 50/60 Hz
- Integral step-down transformer for 347V & 480V
- Ambient operating temperature -40° C to 40° C
- Automatic thermal self-protection
- Drivers have greater than 90% power factor and less than 10% THD
- Optional continuous dimming to 10% or dual circuitry available

- LED drivers have output power over-voltage, over-current protection and short circuit protection with auto recovery
 - 1050 mA driver available with 90L configuration for increased lumen output
 - LED electrical assembly, including PR devices, consumes no power in the 'off' state
 - Field replaceable surge protection device provides 20KA and 10KV protection meeting ANSI/IEEE C62.41.2 Category C High and Surge Location Category C3. The SPD is designed with a clamping voltage of 1600V at 20KA using industry standard 8/20µs waveform.
- Controls:**
- Features exclusive wiHUBB technology
 - Wireless system for On/Off and 0-10VDC full range dimming control
 - Programmable autonomous operation
 - Drivers are 0-10V dimming standard. Photocell and occupancy sensors available for complete on/off and dimming control

Lumen maintenance:

- L90 at 60,000 hours (Projected per IESNA TM-21-11)

Installation:

- Two die-cast aluminum arm designs: The decorative arm offers a sleek upswept look while the straight arm follows the housing's contoured lines for continuity of style
- Fixture ships with arm installed for ease of installation and mounts to #2 drill pattern
- Wall bracket, mast arm fitter and pole accessories are also available allowing easy mounting for virtually any application

Finish:

- TGIC thermoset polyester powder paint finish applied at nominal 2.5 mil thickness

Warranty:

Five year limited warranty (for more information visit: <http://www.hubbelloutdoor.com/resources/warranty/>)

Listings:

- Listed to UL1598 and CSA C22.2#250.0-24 for wet locations
- Models meet DesignLights Consortium (DLC) qualifications, consult DLC website for more details: <http://www.designlights.org/QPL>
- IDA approved • IP65

PRODUCT IMAGE(S)



90 LED 3/4 VIEW



30 LED



60 LED



90 LED

DIMENSIONS

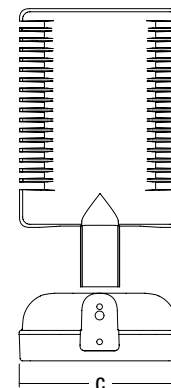
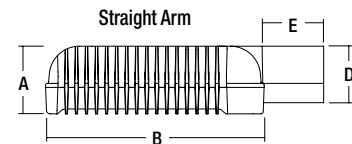
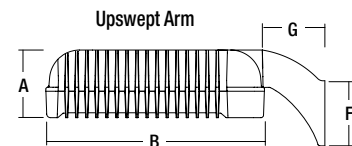

A	B	C	D	E	F	G
6 3/4"	21 3/4"	16"	6 5/8"	6 5/16"	5 5/8"	6 1/8"
171mm	552mm	406mm	168mm	160mm	143mm	155mm

CERTIFICATIONS/LISTINGS



ORDERING INFORMATION SEE NEXT PAGE



Spaulding Lighting • 701 Millennium Boulevard • Greenville, SC 29607 • Phone: 864-678-1000
Due to our continued efforts to improve our products, product specifications are subject to change without notice.

© 2014 SPAULDING LIGHTING, All Rights Reserved • For more information visit our website: www.spauldinglighting.com • Printed in USA CL1LED-SPEC 10/14



ORDERING INFORMATION ORDERING EXAMPLE: CL1-A-90LU-5K-3-DB-RPA3

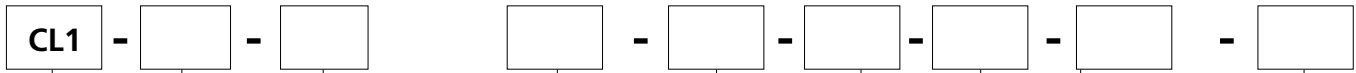

SERIES	NO. OF LEDs	VOLTAGE	CCT	DRIVE CURRENT	OPTIONS
CL1 Cimarron LED	90L 90 High brightness LEDs 60L 60 High brightness LEDs 30L 30 High brightness LEDs	U³ Universal 120V-277V, 50/60 Hz 1⁷ 120V 2⁷ 208V 3⁷ 240V 4⁷ 277V 5 480V, 60 Hz F 347V, 60 Hz E⁴ 220V, 50 Hz	3K 3000K 4K 4000K 5K 5100K AM⁸ Amber (590 nm available for "Turtle Friendly" applications (consult factory))	Leave blank for 700mA (standard) 035 350mA Amber CCT only 105 1050 mA (use with 90L only for higher lumen output)	BC⁶ Backlight control BL^{1,2,5} Bi-level control CD² Continuous dimming WB Wall bracket RPA3 3" Round pole adapter RPA4 4" Round pole adapter RPA5 5" Round pole adapter RPA6 6" Round pole adapter F(X)^{3,4} Fusing (replace X with voltage: 1-120V, 2-208V, 3-240V, 4-277V, 5-480V, 6-347V) SSB Stainless steel LED bezel VG Vandal guard

MOUNTING

- A** Arm mount construction (6" straight rigid arm included & acceptable for 90° configurations)
- AD** Decorative arm mount const. (6" decorative upswept arm incl. & acceptable for 90° configurations)
- MAF** Mast arm fitter for mounting to standard 2 3/8" mast arm bracket, includes 6" straight rigid arm

DISTRIBUTION

- 2** Type II
- 3** Type III
- 4** Type IV
- 5M** Type V Medium
- 5S** Type V Short
- 5W** Type V Wide
- 2L** Type II Rotated 90° left
- 3L** Type III Rotated 90° left
- 4L** Type IV Rotated 90° left
- 2R** Type II Rotated 90° right
- 3R** Type III Rotated 90° right
- 4R** Type IV Rotated 90° right
- 1A** Auto Front Row Type I
- 1AR** Auto Front Row Type I Rotated 90° right
- 1AL** Auto Front Row Type I Rotated 90° left
- 2A** Auto Front Row Type II
- 2AR** Auto Front Row Type II Rotated 90° right
- 2AL** Auto Front Row Type II Rotated 90° left

COLOR

- DB** Dark Bronze
- BL** Black
- WH** White
- GR** Gray
- PS** Platinum Silver
- RD** Red (premium color)
- FG** Forest Green (premium color)
- CC** Custom Color

CONTROL OPTIONS

- SCO¹⁰** Motion sensor On/Off control, No light output when no motion detected
- SCP^{9,10}** Programmable motion control, factory default is 10%
- PR(X)⁵** NEMA Photo cell receptacle (replace X with voltage: U=120-277, 5=480, 6=347)
- WIH⁷** In-fixture wireless control module (120, 277, 347 & 480V)

Notes: 1- For BL option 90L and 60L; N/A 347V & 480V
 2- BL & CD cannot be combined
 3- Fuse option not available with universal voltage
 4- Select F3 fusing option for 220V
 5- Photocell receptacle not available with BL option
 6- Recommended for Type III and IV distributions only
 7- Select only when using voltage specific option (F or WIH)
 8- Available in 350mA drive current only Type IV, 5M
 9- 0-10V fully adjustable dimming with automatic daylight calibration and different time delay settings, must order minimum of one remote control to program dimming settings (see accessories)
 10- 120V/277V/347V/480V only

[Controls Guide](#)

ENERGY SAVING DATA

ENERGY DATA		INPUT WATTS		LUMENS DELIVERED						DRIVERS CURRENT
Power Factor	>.9	120V-277V	347V-480V	TYPE 2	TYPE 3	TYPE 4	TYPE 5M	TYPE 5S	TYPE 5W	CURRENT
Total Harmonic Distortion	<10%									
30L-5K	70	87	6384	6164	6641	7108	6999	6619	2@700mA	
60L-5K	140	157	13300	12842	13125	13185	13675	12954	4@700mA	
90L-5K	210	227	19684	19006	19202	20592	19610	18973	6@700mA	
90L-5K-105	336	363	26974	25351	26548	25793	27445	25195	6@1050mA	
30L-4K	70	87	6089	6109	6104	6417	6439	6046	2@700mA	
60L-4K	140	157	11583	11468	12036	12038	12581	11807	4@700mA	
90L-4K	210	227	17143	16973	17648	18521	20220	17394	6@700mA	
90L-4K-105	336	363	23896	23912	24199	24583	25357	23128	6@1050mA	
30L-3K	70	87	4606	4668	4686	4858	4902	4601	2@700mA	
60L-3K	140	157	9013	9175	9216	9409	9461	8844	4@700mA	
90L-3K	210	227	13360	13601	13575	13923	14004	13902	6@700mA	
90L-3K-105	336	363	17645	17612	17469	17950	18271	17330	6@1050mA	

AUTOMOTIVE DEALERSHIP OPTICS

For Automotive Dealership applications Spaulding Lighting has developed two optics designed for enhanced and proper lighting of the auto dealership merchandise and the front row 1A and interior rows 2A (See CL1 distribution information for details)

Optic 1A

- Maximum illumination on front row display
- Maximum pole spacing

Optic 2A

- Excellent front row illumination and drive lane
- Optimal uniformity for drive lane and interior rows

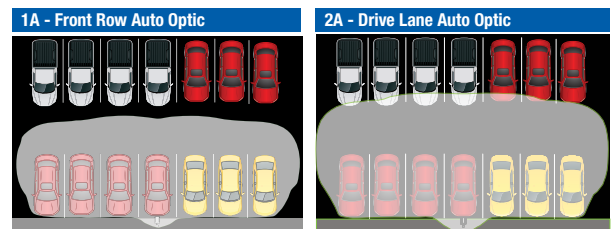

ACCESSORIES SEE NEXT PAGE



Spaulding Lighting • 701 Millennium Boulevard • Greenville, SC 29607 • Phone: 864-678-1000
 Due to our continued efforts to improve our products, product specifications are subject to change without notice.
 © 2014 SPAULDING LIGHTING, All Rights Reserved • For more information visit our website: www.spauldinglighting.com • Printed in USA CL1LED-SPEC 10/14



ACCESSORIES

Catalog Number	Description
SCP-REMOTE ⁹	Remote control for SCP option. Order at least one per project to program and control.

Catalog Number	Description
CR-RPA3-XX ¹	Round pole adapter for straight arm (3/4" - 3 3/4")
CR-RPA4-XX ¹	Round pole adapter for straight arm (3 7/8" - 4 1/2")
CR-RPA5-XX ¹	Round pole adapter for straight arm (5")
CR-RPA6-XX ¹	Round pole adapter for straight arm (6")
CRD-RPA2-XX ¹	Round pole adapter for upswept arm (2 3/4" - 3 1/8")
CRD-RPA3-XX ¹	Round pole adapter for upswept arm (3 1/4" - 3 3/4")
CRD-RPA4-XX ¹	Round pole adapter for upswept arm (3 7/8" - 4 1/2")
CRD-RPA5-XX ¹	Round pole adapter for upswept arm (5")
CRD-RPA6-XX ¹	Round pole adapter for upswept arm (6")
WB-CR-XX ¹	Wall bracket
TPLB-XX ¹	Twin parallel luminaire bracket
MAF-CL-XX ³	Horizontal mast arm fitter for 2 3/8" OD arm. Mounts to standard 6" arm (ordered with fixture)

1 Replace XX with color choice, eg.: DB for Dark Bronze

2 When ordering poles, specify Pole Drill Pattern #2

3 Fixture must include standard 6" arm

MOUNTING ACCESSORIES

Catalog Number	Description
ARM-CL-K-TA-XX ¹	Adjustable mounting arm for single fixture (2-3/8 tenon) – 5 lbs. 2.3 kgs.
ARM-CL-TK-TA-XX ¹	Adjustable mounting arm for two fixtures at 180° (2-3/8 tenon) – 7 lbs. 3.2 kgs.
ARM-CL-K-S-XX ¹	10" adjustable arm – .5 lbs. .05 kgs. – 5.75 lbs. 2.6 kgs.

1 Replace XX with color choice, eg.: DB for Dark Bronze

2 Fixture must include standard 6" straight arm

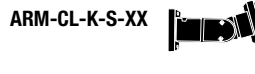
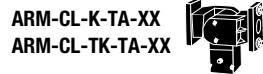

TENON TOP POLE BRACKET ACCESSORIES

(2 3/8" OD tenon) (RSS version requires 4" round pole adapter)

Catalog Number	Description
SETA-XX ¹	Square pole tenon adapter (4 at 90 degrees)
RETA-XX ¹	Round pole tenon adapter (4 at 90 degrees)
TETA-XX ¹	Hexagonal pole tenon adapter (3 at 120 degrees)

1 Replace XX with color choice, eg.: DB for Dark Bronze

PHOTOCONTROL EQUIPMENT

Catalog Number	Description
PTL-1	Photocontrol - twist-lock cell (120V)
PTL-8	Photocontrol - twist-lock cell (120-277V)
PTL-5	Photocontrol - twist-lock cell (480V)
PTL-6	Photocontrol - twist-lock cell (347V)
PSC	Shorting cap - twist-lock

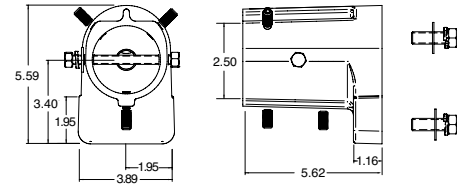

MAF – HORIZONTAL MAST ARM FITTER

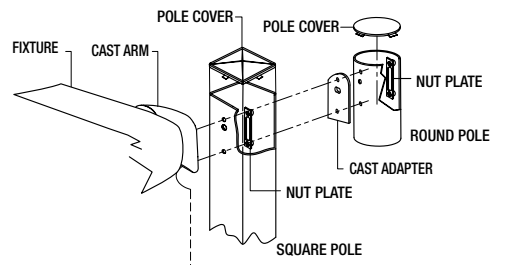

UPSWEPT ARM MOUNT SQUARE & ROUND POLES

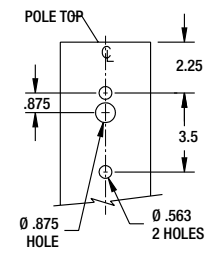

#2 DRILL PATTERN FOR POLES

LIGHTING FACTS

LED lighting facts
A Program of the U.S. DOE

Light Output (Lumens) **6270**
Watts **68.4**
Lumens per Watt (Efficacy) **91**

Color Accuracy
Color Rendering Index (CRI) **74**

Light Color
Correlated Color Temperature (CCT) **4021 (Bright White)**

Warranty** **Yes**

Registration Number: A25K-Z2G78D (11/2/2012)
Model Number: CL1-A-30LU-4K-3
Type: Outdoor area/roadway fixture

LED lighting facts
A Program of the U.S. DOE

Light Output (Lumens) **6892**
Watts **69.7**
Lumens per Watt (Efficacy) **98**

Color Accuracy
Color Rendering Index (CRI) **68**

Light Color
Correlated Color Temperature (CCT) **5008 (Daylight)**

Warranty** **Yes**

Registration Number: A25K-F1W945 (11/2/2012)
Model Number: CL1-A-30LU-5K-3
Type: Outdoor area/roadway fixture

LED lighting facts
A Program of the U.S. DOE

Light Output (Lumens) **15056**
Watts **208.8**
Lumens per Watt (Efficacy) **72**

Color Accuracy
Color Rendering Index (CRI) **76**

Light Color
Correlated Color Temperature (CCT) **5433 (Daylight)**

Warranty** **Yes**

Registration Number: A25K-1BWH5 (11/2/2011)
Model Number: CL1-AD-90L-1-5K-3
Type: Outdoor area/roadway fixture

LED lighting facts
A Program of the U.S. DOE

Light Output (Lumens) **22898**
Watts **339.5**
Lumens per Watt (Efficacy) **67**

Color Accuracy
Color Rendering Index (CRI) **75**

Light Color
Correlated Color Temperature (CCT) **4102 (Bright White)**

Warranty** **Yes**

Registration Number: A25K-RFEAAX (11/2/2012)
Model Number: CL1-A-90LU-4K-2-105
Type: Outdoor area/roadway fixture



Spaulding Lighting • 701 Millennium Boulevard • Greenville, SC 29607 • Phone: 864-678-1000
Due to our continued efforts to improve our products, product specifications are subject to change without notice.
© 2014 SPAULDING LIGHTING, All Rights Reserved • For more information visit our website: www.spauldinglighting.com • Printed in USA CL1LED-SPEC 10/14

